

KS3 Assessment, Recording and Reporting

what you do
**EVERY
DAY**
matters more than
what you do
**EVERY
ONCE**
in a while.

Mrs Collier

Barnwell School
MIDDLE & UPPER



Show My Homework Log In

satchel:one

For access to Show My Homework

Login

[Forgot password?](#)

Staff

Parent

Student

Barnwell School

Enter email address or username

Enter password



Log in

Or log in with:



Sign in with Office 365



Sign in with Google



Sign in with RM Unify

Need help logging in?

[Logging in as a staff member](#)

Enter your school email address and password to access your account

Forgot password?

Reset your password using your school email address.

Email not recognized?

Ensure there are no typos or try a different email address. If you are still unable to reset your password, contact your school administrator who will be able to update your contact details.

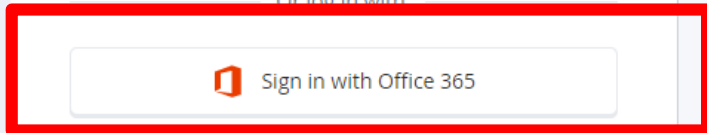

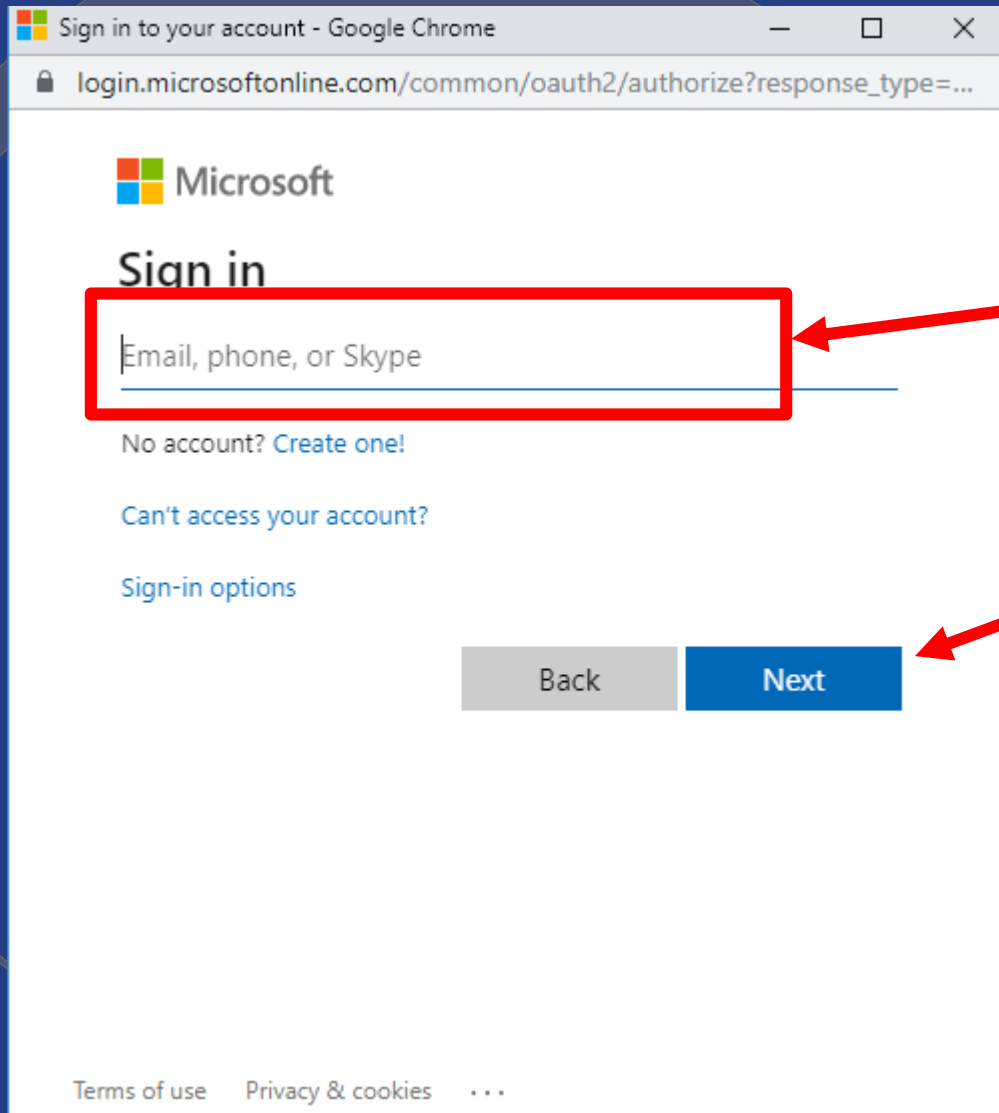

Students have this in their planners.

Click 'Next' and enter the password they use to log on to the computers in school



If you have a laptop at home but don't have Office (Word, Powerpoint, Excel), students can download this using Office 365

Office 365 Login | Microsoft Office

<https://www.office.com> ▼

Collaborate for free with online versions of **Microsoft** Word, PowerPoint, Excel, and OneNote. Save documents, spreadsheets, and presentations online, ...



Sign in

No account? [Create one!](#)

[Can't access your account?](#)

[Sign-in options](#)

Back

Next

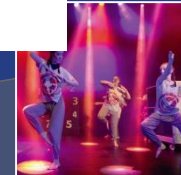

You can install Office on up to 5 devices.
You will need to enter your child's email address and password to activate the license.

Good afternoon

Install Office ▾

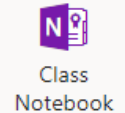
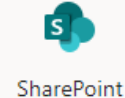
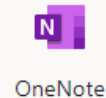

Sway

Forms

All apps

When your child leaves the school you will no longer have access to Office.



CHANGES TO EDUCATION

- Progress 8/Attainment 8 – New Measures
- Numbers not grades
- BTECs
- Exams
- New Courses



The New Number System...

New grading structure	Current grading structure
9	
8	A*
7	A
6	B
5	Strong Pass
4	Standard Pass
3	D
2	E
1	F
	G
U	U



Data Tracks

3 Data Tracks through the year

- End of Year 11 Target Grade
- ‘**Well below target**’ expected progress
- ‘**Just below target**’ expected progress
- ‘**On target**’ expected progress
- ‘**Above target**’ expected progress



OUR EXPECTATION...

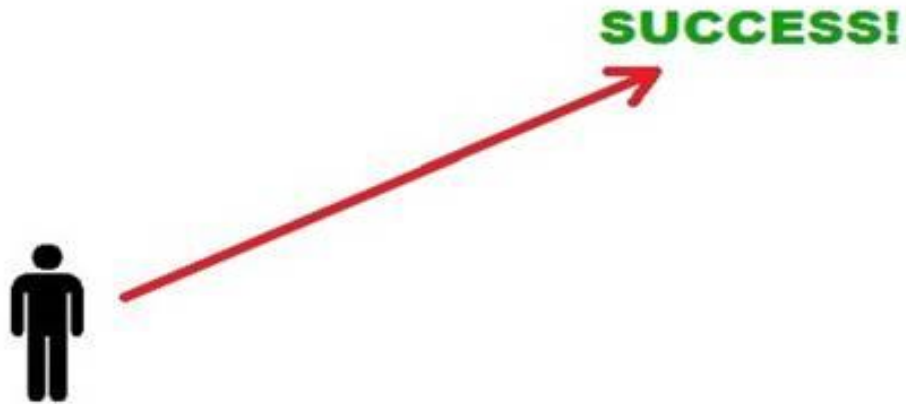

OUR REALITY...

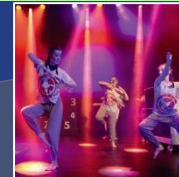
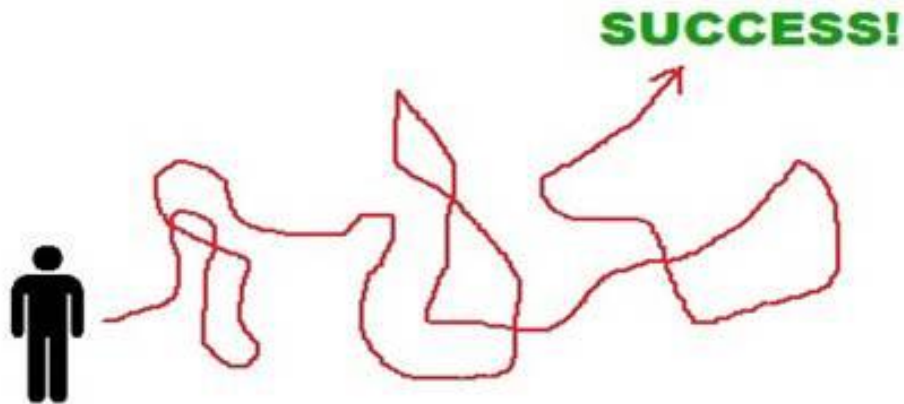

Personalised Learning Checklists (PLCs)

PLC – Recording Ideas Visual and Written Communication

Year 7 Autumn Term 1: Insects	Name:			R	A	G
Experimenting with drawing						
<ul style="list-style-type: none"> Identify the colours with accuracy Experiment with mixing colours, using red, blue and yellow Control the use of your colours (dark & light) – by introducing black or applying less pressure. 						
<ul style="list-style-type: none"> Control tone from dark to light – rendering Apply dark and light tones considering light direction Show ‘form’ in your piece – i.e. 3D not flat 						
<ul style="list-style-type: none"> Blend colours with accuracy – controlling the tones of your colours and explore making new tones by blending different colours together Identify textures – soft, rough using different mark-making/blending techniques 						
<ul style="list-style-type: none"> Explore further techniques of applying colour marks e.g. expressive lines, cross hatching (applying a different artist focus). 						
<ul style="list-style-type: none"> Explore presentation of piece to show pride within work 						

ABOVE TARGET	ON TARGET	BELOW TARGET	WELL BELOW TARGET
---------------------	------------------	---------------------	--------------------------



Still Confused?



Further Information...

- Email:

k.collier@barnwell.herts.sch.uk

- Phone:

01438 222500

